

Get Reconstitution Down **PAT**

How to use Kogenate® FS with BIO-SET

Before using the **Kogenate® FS with BIO-SET®** needleless reconstitution system:

- Work on a clean surface and wash your hands well
- If you refrigerate **Kogenate® FS with BIO-SET®**, warm the vial and syringe in your hands until they reach room temperature.

Call your healthcare provider if you have any questions.

PREPARE

1 Open

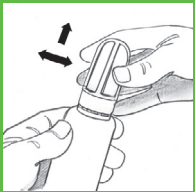

The easiest way to remove the cap from the vial is to move the top from side to side while pulling upward at the same time. This breaks the small plastic tabs that connect the cap to the top of the vial.

2 Remove Tip Cap



Remove the tamper-evident tip cap from the syringe by gently breaking it off.

3 Connect Syringe



Connect the prefilled syringe to the power vial by gently screwing it on clockwise. Do not overtighten.

ACTIVATE

4 Activate

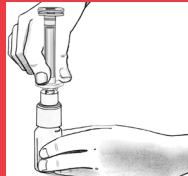

Place the vial on a solid, nonskid surface. Hold the vial firmly with one hand. With the other hand, place your thumb and forefinger on the

fingerplate of the syringe, and press firmly on the fingerplate until it meets the top of the powder vial.

This is the most critical step in the process.

5 Connect Plunger Rod



Grasp the plunger rod at the top and remove it from the blister pack. Immediately connect it to the syringe by screwing it clockwise into the rubber stopper.

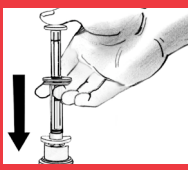

6 Inject

Inject diluent into the vial by slowly pressing down the plunger rod.

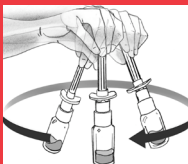

7 Mix

Mix by swirling gently and slowly. **DO NOT SHAKE THE VIAL.** Be sure the powder is completely dissolved before using.

TRANSFER

8 Transfer

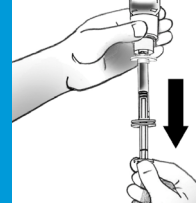

Invert the vial with the syringe still attached and draw the solution into the syringe.

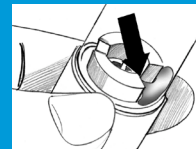

Tilt the vial to the side and back to check that all solution has been drawn into the opening in the rubber stopper.

9 Disconnect

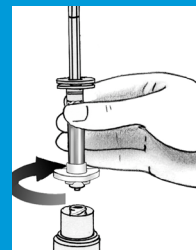

Disconnect the syringe from the empty vial by unscrewing it counterclockwise.

DO NOT PULL THE SYRINGE FROM THE VIAL WITHOUT UNSCREWING IT FIRST.



10 Infuse

Attach the syringe to the butterfly set by screwing it in clockwise, and follow your normal infusion procedure.



Bayer Australia Limited ABN 22 000 138 714
875 Pacific Highway, Pymble, NSW 2073
© Registered Trademark of Bayer AG
BIO-SET® is a registered trademark of Biodome SAS



Octocog alfa (bhk) – Recombinant Factor VIII